

## Installation to Hilux 09/2021 on... Dual & Extra Cab PART NO. RCHI21S

### \*Bluetooth Connectivity to Console body

Remove Factory fitted light pod from roof. To do this, push fingers between Light Pod assembly and roof lining in the centre on the rearwards edge. Gently pull down on assembly until Pod has unclipped. Repeat process on the front centre of Pod, and Pod will detach from roof cavity. Ensure the 4 x RED trim plugs are removed with the Pod assembly. Unplug the vehicle wiring connector block from the Light Pod Assembly. On a soft protected surface, unclip small connector Block from Bluetooth Microphone. Remove the seven (7) screws holding the Backing Cover and Printed circuit board to Pod. Remove circuit board and backing cover. Carefully prise out Bluetooth 'Microphone Pick-Up' from Pod. Half twist and remove light globes from Circuit board. Put Light Pod, backing cover, 2 x globes and 7 x screws aside in a safe place for vehicle refit back to original if required.

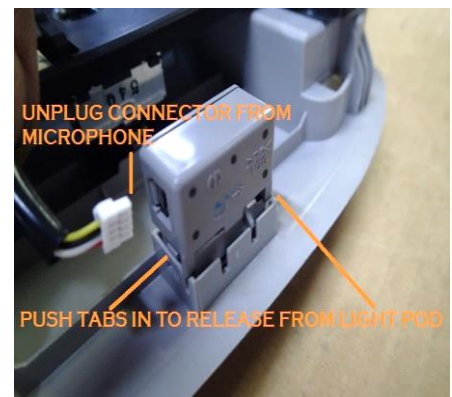

### S.O.S BUTTON connectivity to console body

**Bluetooth Circuit Board and SOS attachment to console:** Switch the Light Pod 'ON/OFF' lever switch on underside of circuit board in the away → direction from connector block, and bend Toggle to 45°. This will leave the front lighting circuit in the 'OFF' position, and toggle switch away from console switch when installed. Remove the two (2) clear plastic tabs from SOS housing. Attach the SOS button assembly to circuit board using one (1) M3 x 12 nylon bolt and M3 nut placed in the centre hole. Clean integrated Microphone grille on console body with iso-alcohol, then stick down microphone pick-up foam receptacle over one of these grilles and insert Bluetooth Microphone.

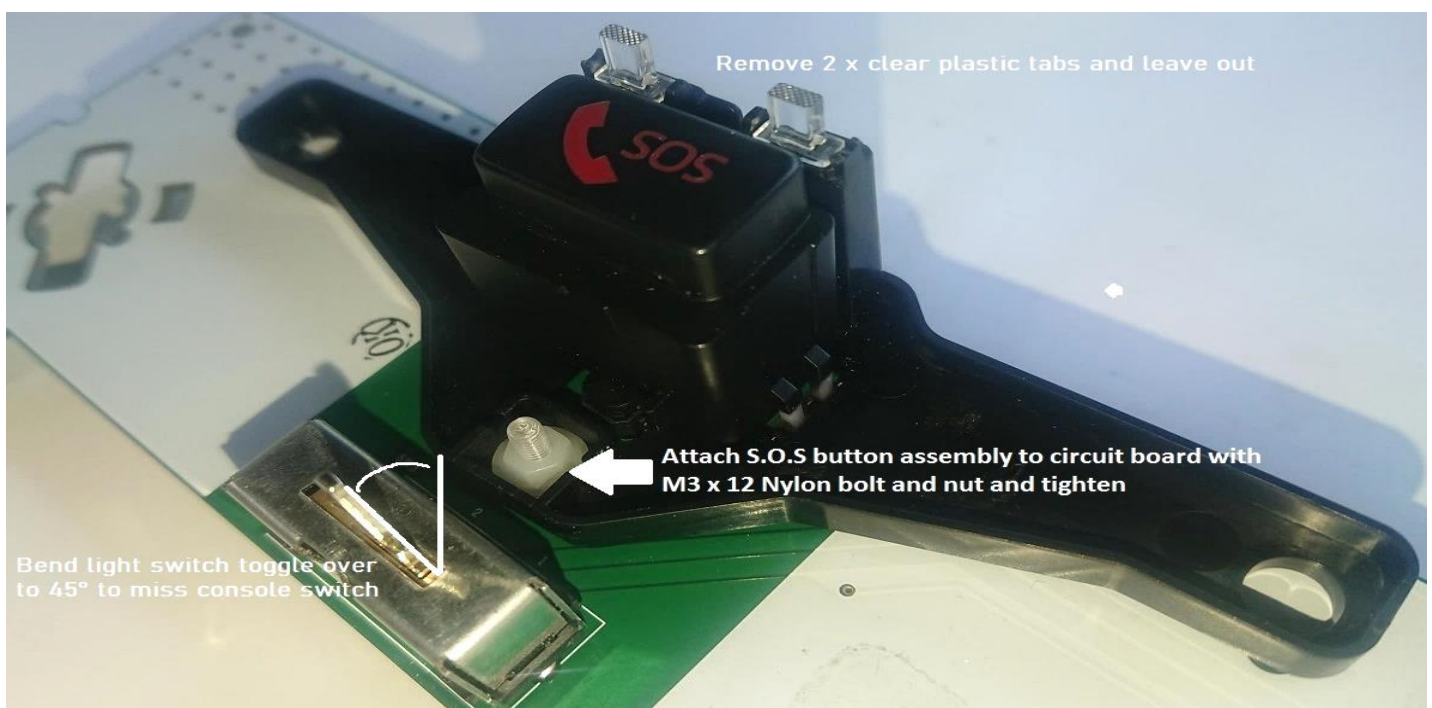

Insert Bluetooth microphone into Foam receptacle attached over the right-hand speaker grille, and re-plug Microphone wire into circuit board. Insert two (2) M3 x 40 black socket bolts through the 3mm holes situated above console radio opening. Slide one piece of 24mm long tubing over bolts then hand tighten firmly M3 white nylon nut to top of tubes, to create two posts for circuit board. (*image1*)

Sit SOS circuit board assembly onto the two posts, then finger tighten circuit board to posts with M3 nylon nuts and a dab of Loctite. (*image2*)

Make sure the SOS button is positioned over rectangle grommet, and you can hear the SOS button clicking freely when depressing and releasing. (*image3*)

**IMPORTANT!!** Perform this test before re-connecting circuit board to vehicle loom.

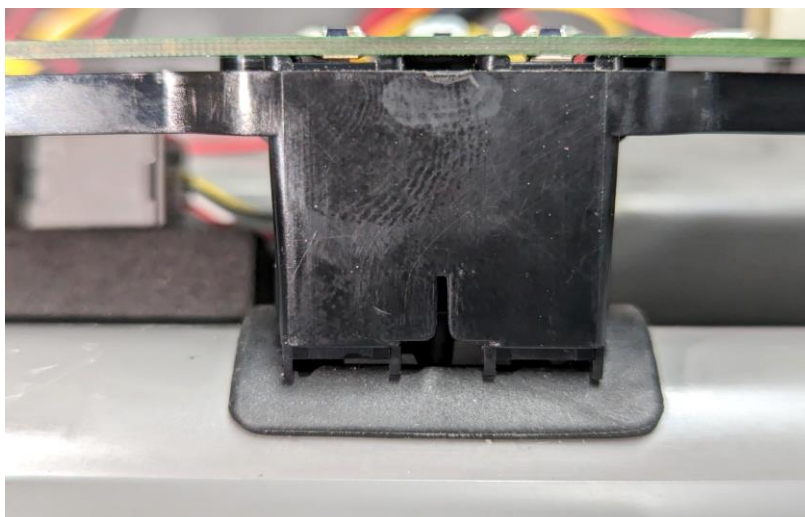
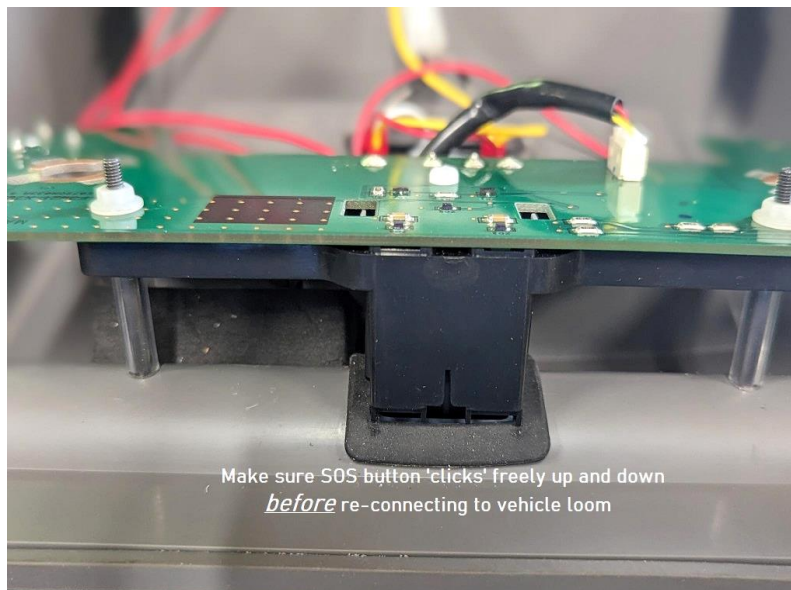
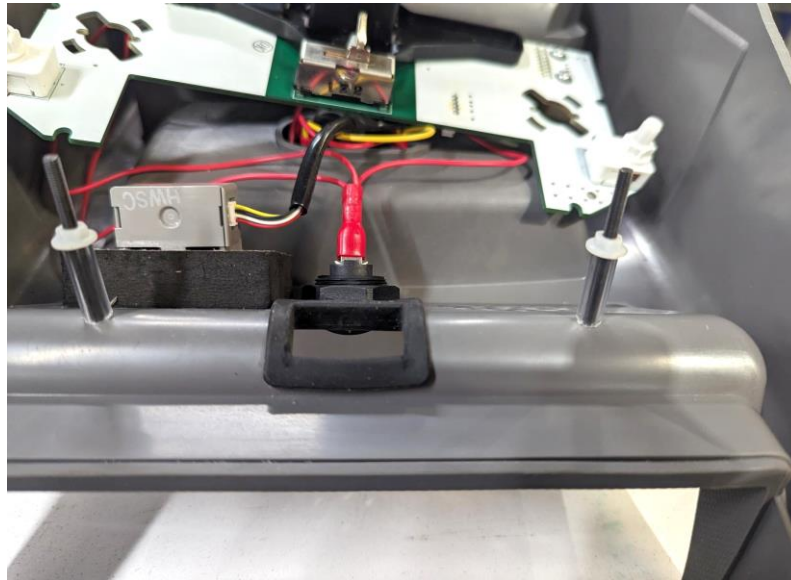

***Failure to connect coloured wiring correctly and tape up all connections as described in the following instructions could result in an electrical short and void console warranty. We strongly suggest this console fitting to be performed by your local 4x4 accessory store.***

For this installation you will need a **long** Phillips screwdriver, **short** 'stumpy' Phillips screwdriver, small flat blade screwdriver, small knife or sharp blade, 3.2mm 'stub' drill bit, electric or Battery drill, electrical insulation tape and Loctite. **Use Loctite on all console screws when installing.** All fixing plates, brackets, fixing screws supplied in fitting kit.

***VEHICLE PREPARATION:***

***Front Mount Bracket Installation:*** Insert the two (2) square plastic grommets supplied in kit into vacant Light Pod holes at 152mm centres. Screw Front Mount Bracket into the two (2) plastic grommets with 10# x 12mm self-tappers.



***Centre Interior light removal:*** Prise off clear lens cover with small flat blade screwdriver or knife. Using the same implement, push the two (2) large diagonally positioned plastic Tabs inwards to release Light assembly from roof lining. To release Wiring Block from Light assembly, push long tab situated at base of the assembly inwards to release wiring block. Remove top cover on wiring block to expose the Interior light wires, and carefully remove each wire from the 'V' grooves. Put interior light assembly aside in safe place for vehicle refit back to original if required.

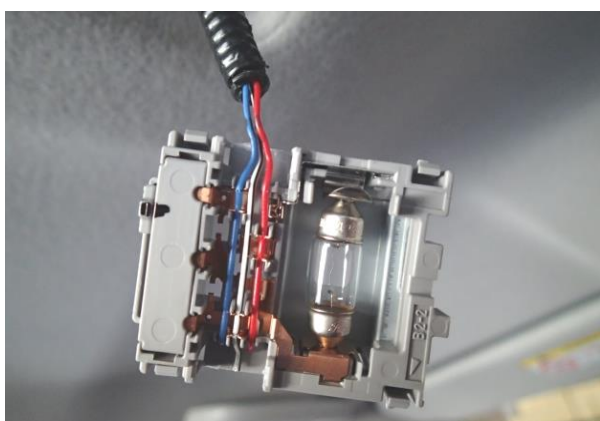
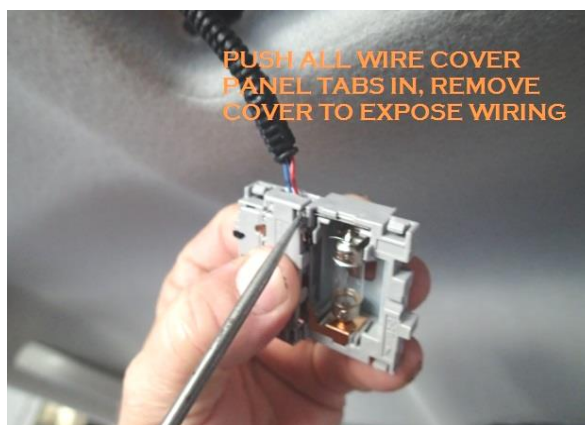
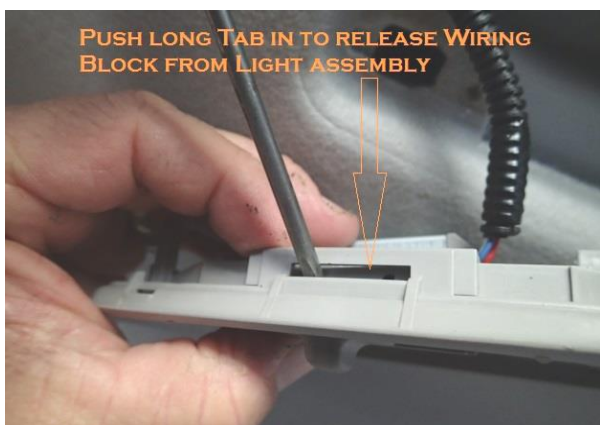

**Rear Mount Plate Installation:** Using the drilling template supplied in the kit, hold template in the Interior light cavity and mark the four (4) holes. **With 20mm maximum of drill bit exposed from chuck**, drill four (4) 3.2mm holes into roof stiffening rib. Place rear mount plate with 20mm spacer blocks attached over the holes and using a **hand held Phillips** screwdriver, fasten the Rear Mount Plate to drilled holes with 8# x 30 self-tapper screws ensuring captive nuts are to **rear** of vehicle and facing down.

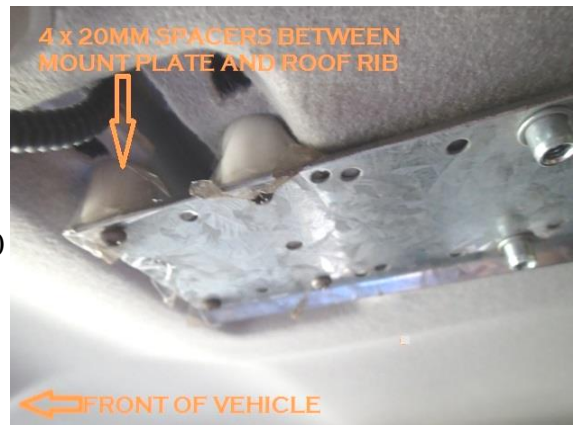

**Installation Preparation:** \*Connect each wire **one at a time**

**Step 1:** strip off approx. 10mm insulated coating from vehicle wire, and twist together with console wiring extension supplied. Twist **Red** to **Red** first.

**Step 2:** Place threaded portion of grey Posi-twist™ connector over the two joined wires, then screw the main body on tight to crimp wires together.

**Step 3:** Repeat steps 1 and 2 for **White** to **Blue** and **Yellow** to **White** wires.

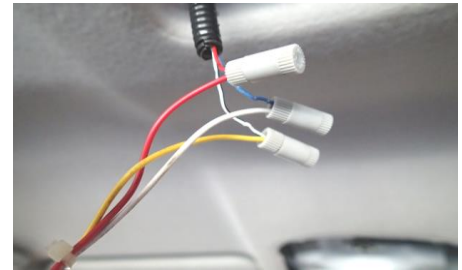

Use 'Blu-Tack' supplied to adhere one of the 6mm x 30mm round head bolts to **long Phillips screw driver** and put a small amount of 'Loctite' on thread then store in convenient location, e.g. on seat of vehicle or in/on centre console.

**Comfortable work position:** Slide seats all way back, if right-handed - sit in passenger seat, if left handed - sit in driver seat. A second person is recommended to make installation easier.

### **CONSOLE INSTALLATION:**

Stand console upright on front seat and plug console wiring loom into interior light/extension loom of vehicle. Plug **red** to **red**, **white** to **white** and **yellow** to **yellow**. Check that console lights work independently once doors are shut and timer switches off (approx. 25 seconds), **then tape up to ensure wires do not become disconnected.**

There is an **'on/off'** switch located above the radio opening. When **'off'** it acts as a kill switch-- **no lights will work.** When **'on'** lights work independently as map/interior lights when doors are shut and timer switches off. When doors are opened lights will work as door/interior lights.

Hold console up close to light pod opening, left to right (**across the width of the cab**) and insert the front connector harness into the circuit board block mounted to console body.

Turn console body 90°, and position **up to Front Mount Bracket** ensuring the Front mount bracket fits into gap between front inner of console body and rear of radio surround/storage tray. Insert one M6 x 16 black Pan head bolt through console into Front Bracket captive nut and finger tighten. Look up under rear mounting hole;

line up captive nuts in Rear Mount Plate with slotted fastening holes, tuck wiring loom down the side out of way so as not to jam between console body and Rear Mount Plate. **Loosely** fasten console up to one of the captive nuts in Rear Mount Plate using the 6mm x 30mm round Phillips head bolt 'Blu-Tacked' to Phillips screw driver.



**Finger** fasten other M6 x 16 black Phillips bolt to Front Mount Bracket. To do this, push up console until hole line up with captive nuts on front bracket. Now tighten both bolts up using **short** Phillips screwdriver.

Blu-Tack other 6mm x 30mm round Phillips head bolt onto screw driver, apply 'Loctite' and fasten into Rear Mount Plate; tighten bolts. **NOTE: Only tighten rear bolts up firm so console is held to roof. DO NOT tighten so as to bend rear mount plate downwards; do rear bolts up with equal tension.**

Open Locker Box and remove Microphone Cable Holder and Rear Mounting Hole Cover from inside. Fasten Hole Cover in place using screws supplied. Fasten Microphone Cable Holder in a convenient location (as per radio installation instructions attached). Ensure microphone position does not foul on sun visor when visor pulled downwards.

## Fit Kit: RCHI21S:

- One (1) Front Mount Bracket
- One (1) Drilling template
- One (1) Rear Mount Plate
- Four (4) 20mm round plastic spacers
- Three (3) Console wiring Posi-twist™ connection terminals
- One (1) Wiring Extension
- Four (4) 8# x 30mm Phillips self-tapping screws
- Two (2) 10# x 12mm Phillips self-tapping screws
- Two (2) 6mm x 30 mm Phillips round head bolts
- Two (2) 6mm x 16mm **black** Phillips round head bolts
- Two (2) square plastic screw grommets
- One (1) Piece of 'Blu-Tack'
- Three (3) 100mm pieces sticky back foam (radio installation)
- Two (2) M3x40 **black** socket head screws
- Two (2) 3mm I/D x 24mm plastic tubing
- Five (5) M3 nylon nuts
- One (1) M3 Nylon bolt

SOS/Circuit board mount

# RADIO INSTALLATION

## Radio Insert Installation for smaller size radios

Decorative side of insert faces outwards and snaps out over bottom of tray surround.

To install insert, squeeze top and bottom together; push/bend sides and squeeze into tray surround from inside to outside until bottom lip on decorative side of insert snaps/pops out over bottom of tray surround, prise with fingers to ensure bottom lip of insert is in place over radio tray surround as described. **Do not** scratch or mark insert or surround by prising/levering with tools; use hands/fingers only.

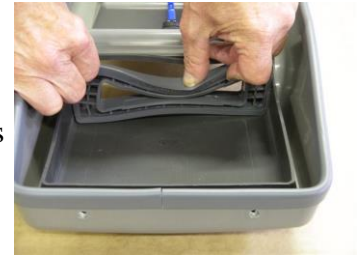

### Radio Installation:

Place protective cover on work bench to avoid scratching console. Place console on protective cover and using a sharp knife cut a 30mm x 100mm section out of radio tray 25mm in from where rear of radio will be when installed. Use a small amount of methylated spirits on a clean cloth to clean exposed part of console and bottom rear of radio.



Peel one side of protective backing from foam strip supplied; apply pressure with palm of hand to adhere foam to exposed part of console body. (Sticky back foam will not adhere to radio tray)

Peel backing off other side of foam strip and add one or more strips of foam to suit different size radios (**see chart below**). This will keep radio level with bottom of insert/surround. Peel off top foam strip to adhere to radio body.



Mount Roof console as per vehicle specific instructions. Lay radio aerial cable and power wires out through radio tray/Insert opening. Connect radio cables and push radio in on an angle through insert until radio face protrudes approx. 15mm out over bottom of tray surround or insert. Use both thumbs to apply upwards pressure on radio, this will adhere radio body to sticky back foam.

**TIP:** smear a light kitchen oil around insert opening to help radio slide in.



### Sticky back foam chart:

One (1) strip- standard DIN size radios

Two (2) strips- Icom and Uniden

Three (3) strips- GME Electrophone



### Microphone handpiece and Microphone Cable Holder installation:

Install in a position that suits best, depending on vehicle and Radio model. Ensure microphone **or** microphone cable and holder does not foul on sun visor when pulled down.



Microphone clip on slight angle



Left hand cable outlet radios



Microphone clip on acute angle